

**Ford Kuga II 03/2013 >> 01/2020**

**Partnr.: FR-066-B1U**

- Fitting instructions electric wiring kit tow bar with 12-N socket up to DIN/ISO Norm 1724.
- We would expressly point out that assembly not carried out properly by a competent installer will result in cancellation of any right to damage compensation, in particular those arising by virtue of the product liability act.
- Contents of these kits and their fitting manuals are subject to alteration without notice, please ensure that these instructions are read and fully understood before commencing installation.
- Do not overload circuits; the maximum loads per connection are detailed in this manual.
- Attention! Before Installation, please read this manual carefully and inform your customer to consult the vehicle owners manual to check for any vehicle modifications required before towing.
- In the event of functional problems, troubleshooting must be limited to about 0.5 hours, contact the technical support:  
[ukts@ecs-electronics.com](mailto:ukts@ecs-electronics.com) / 07440 202 052.



# Part list

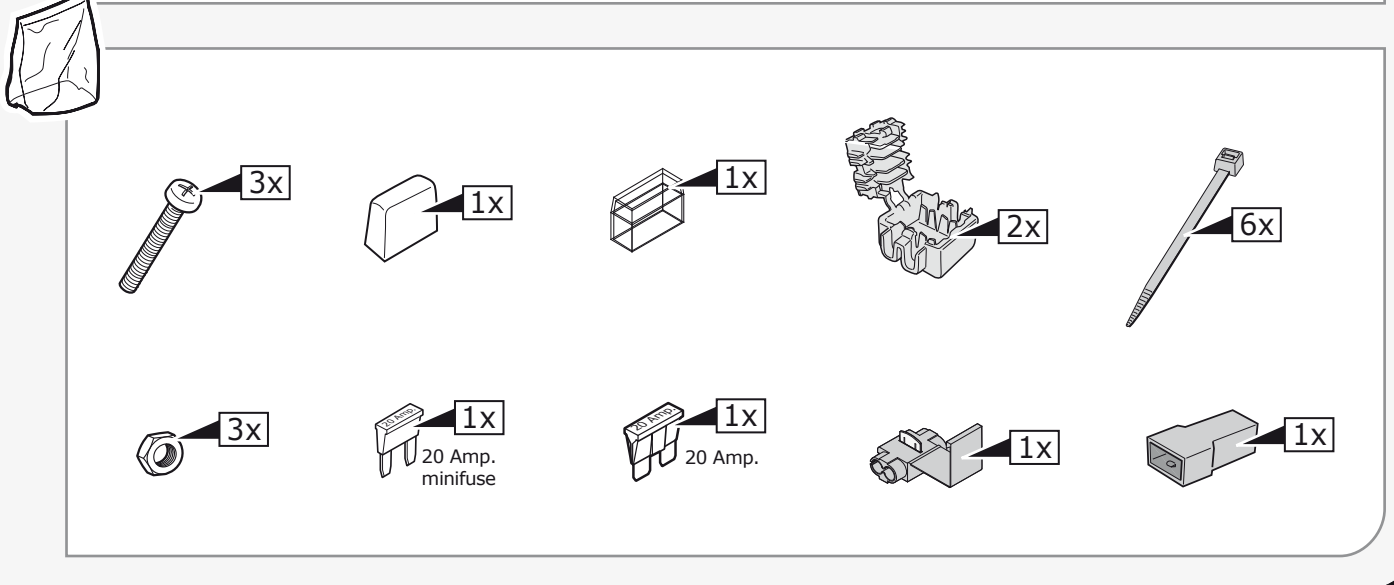
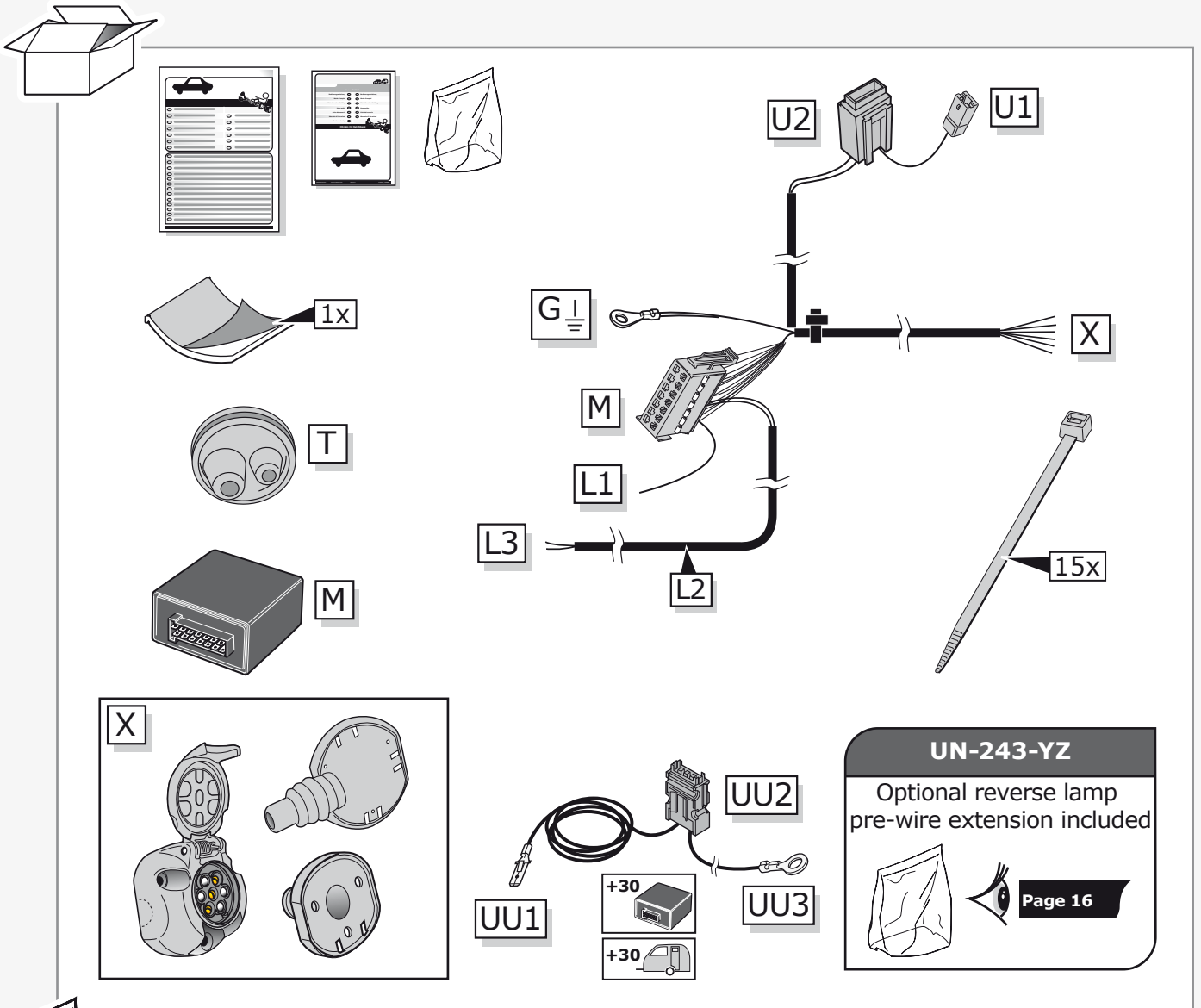

**TOOLS**

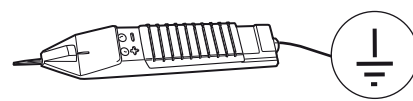
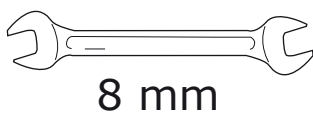
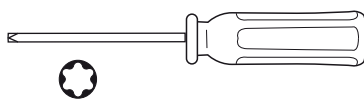
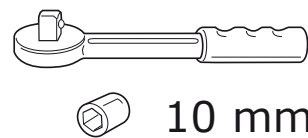
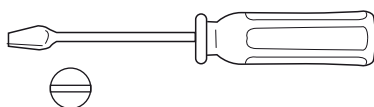
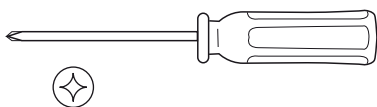

**ROUTING**

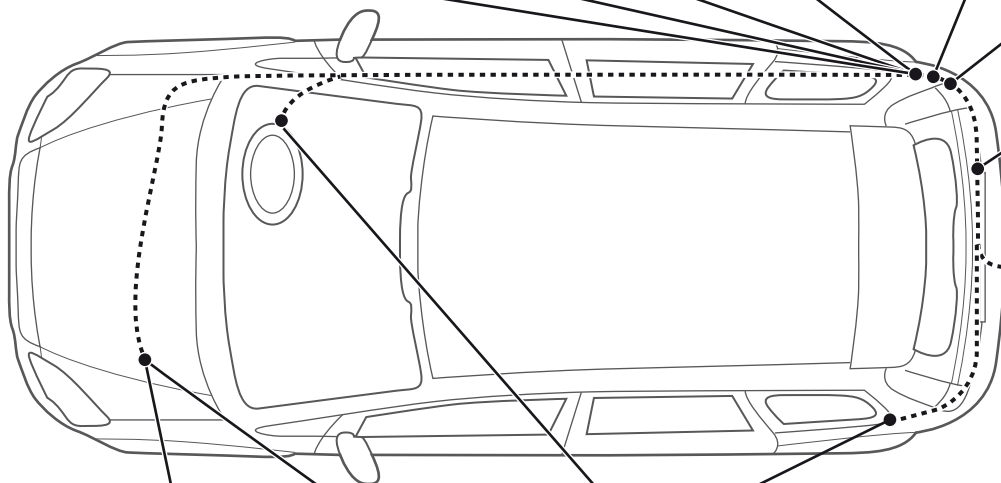
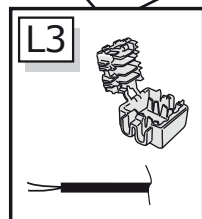
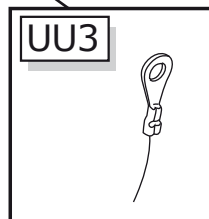
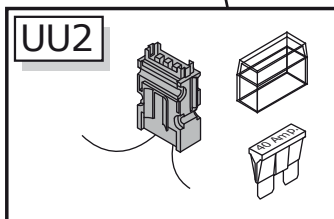
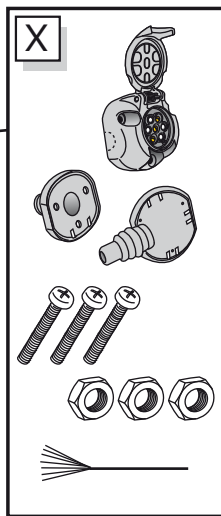
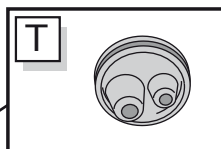
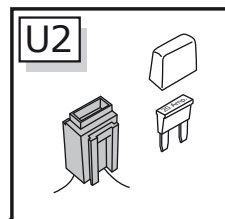
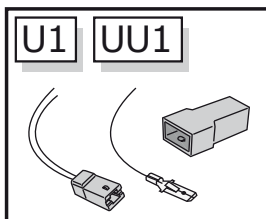
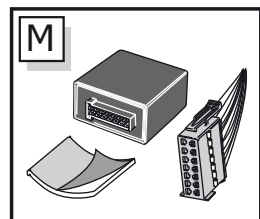
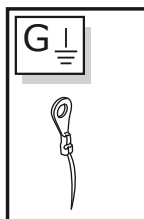
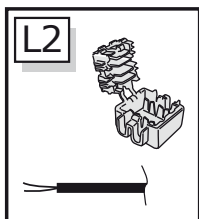
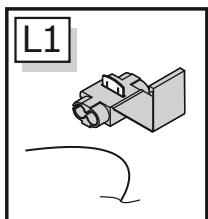

**1**

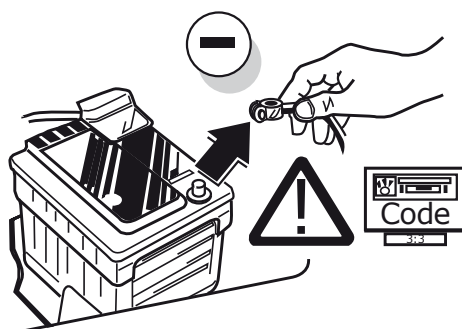

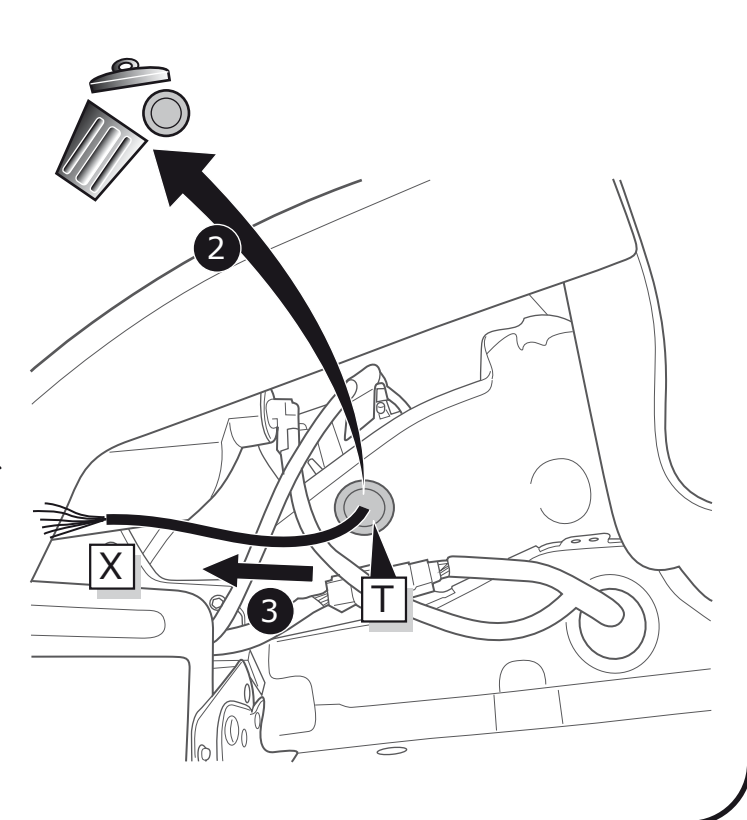
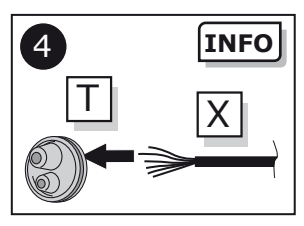
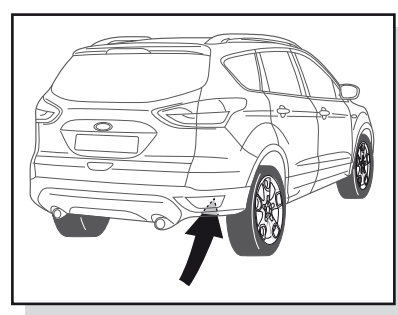
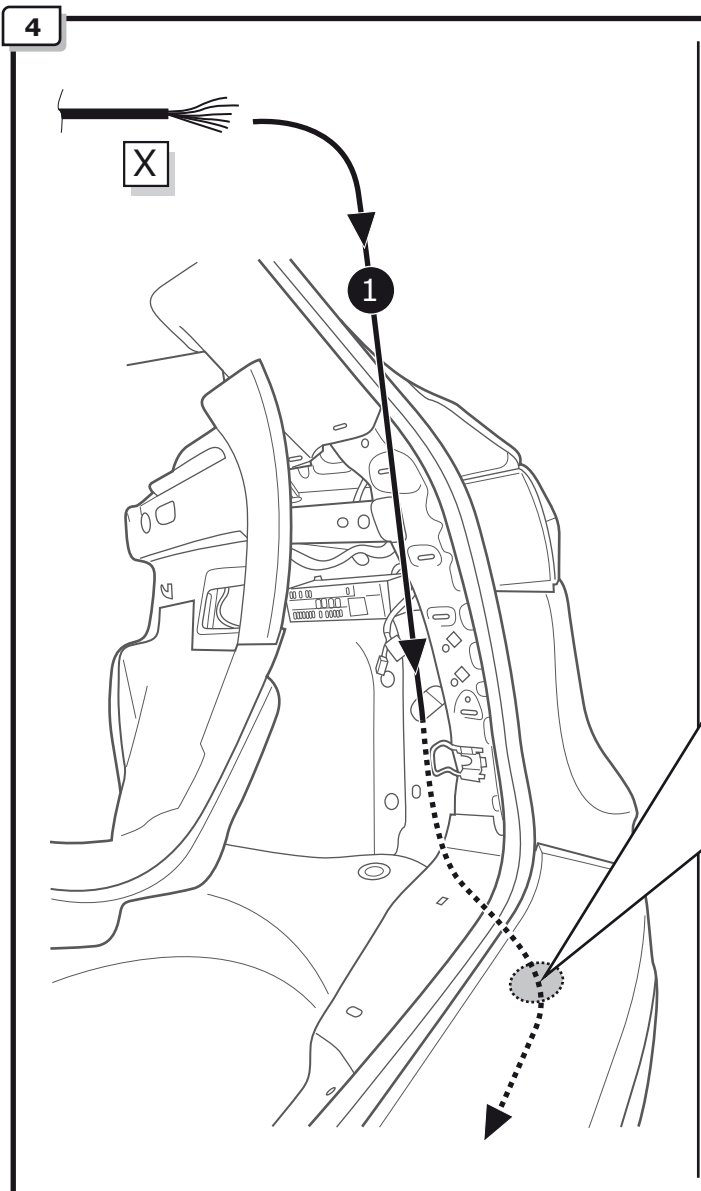
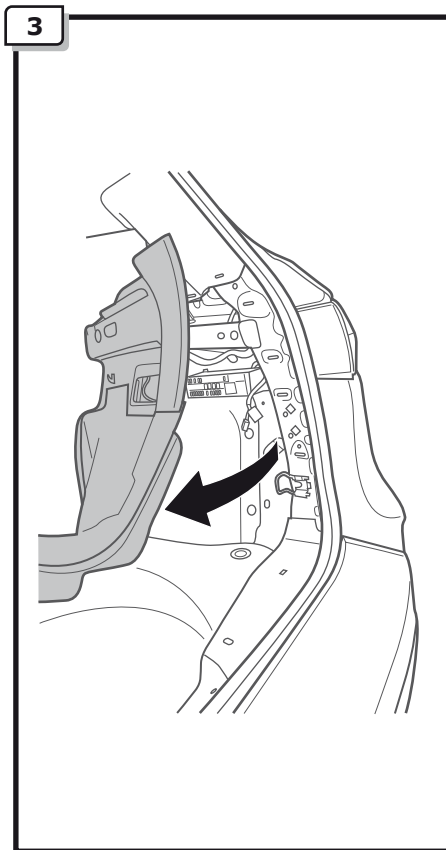
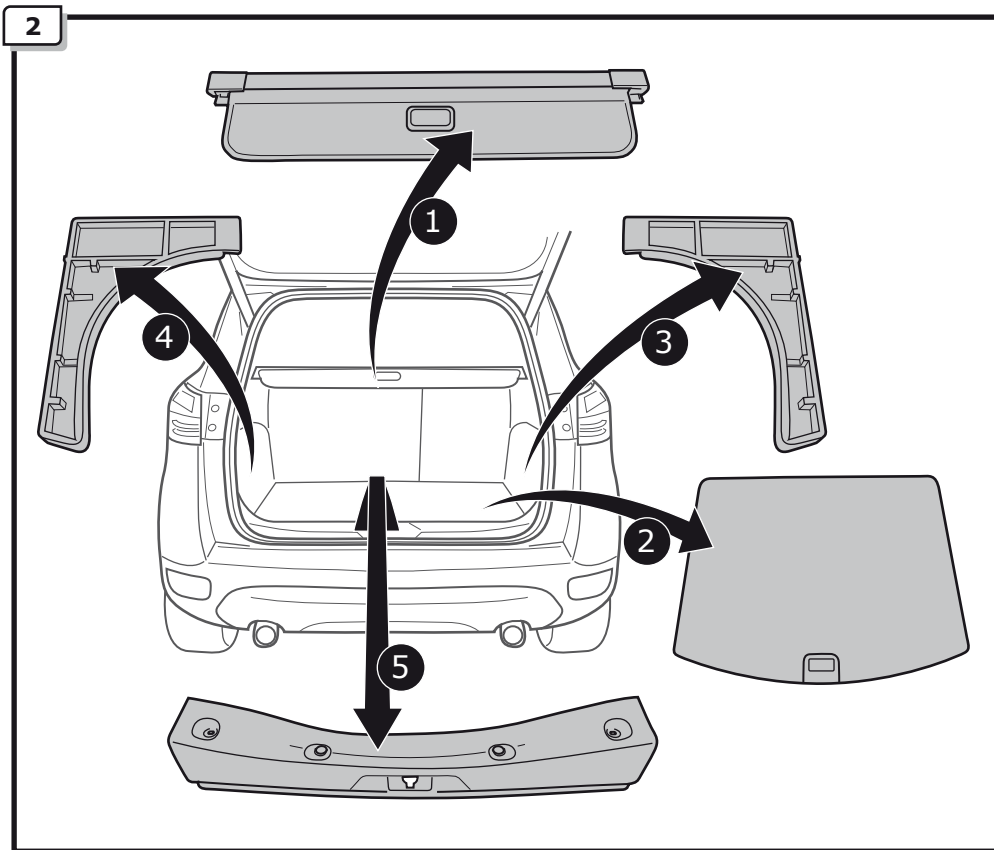

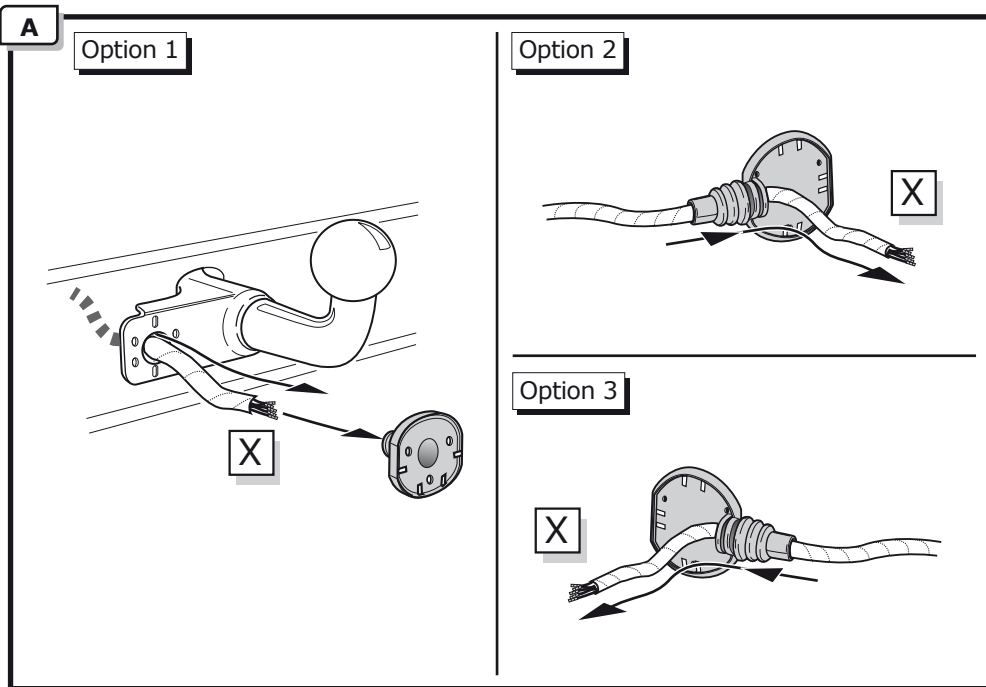

**INFO**

SOCKET CONNECTION

Page 15

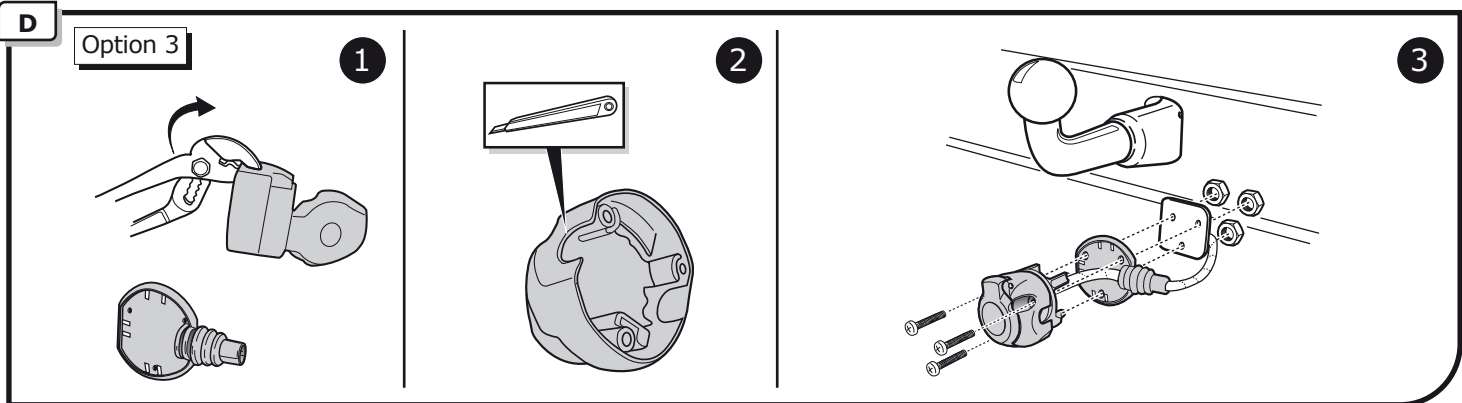
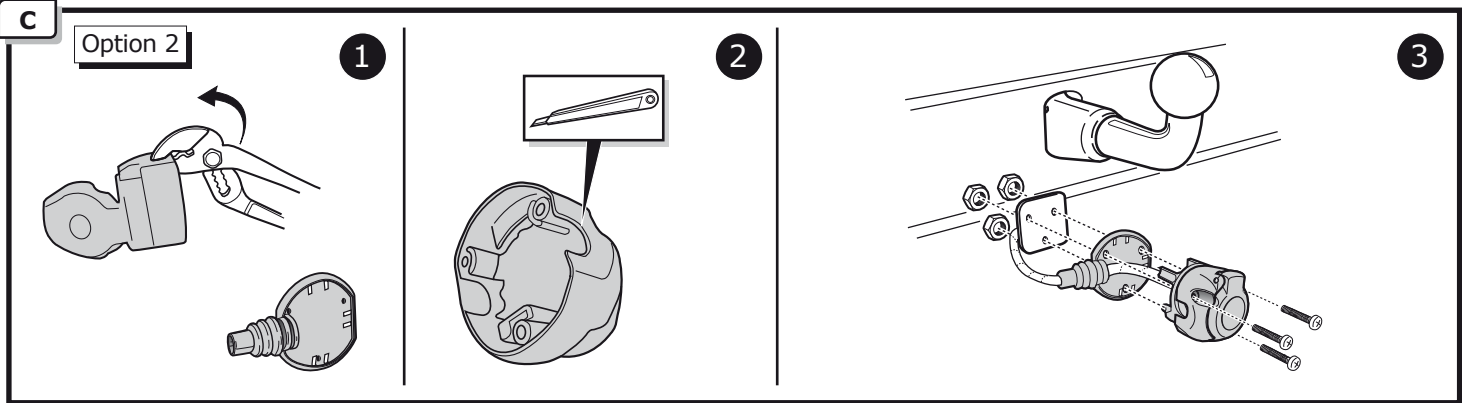
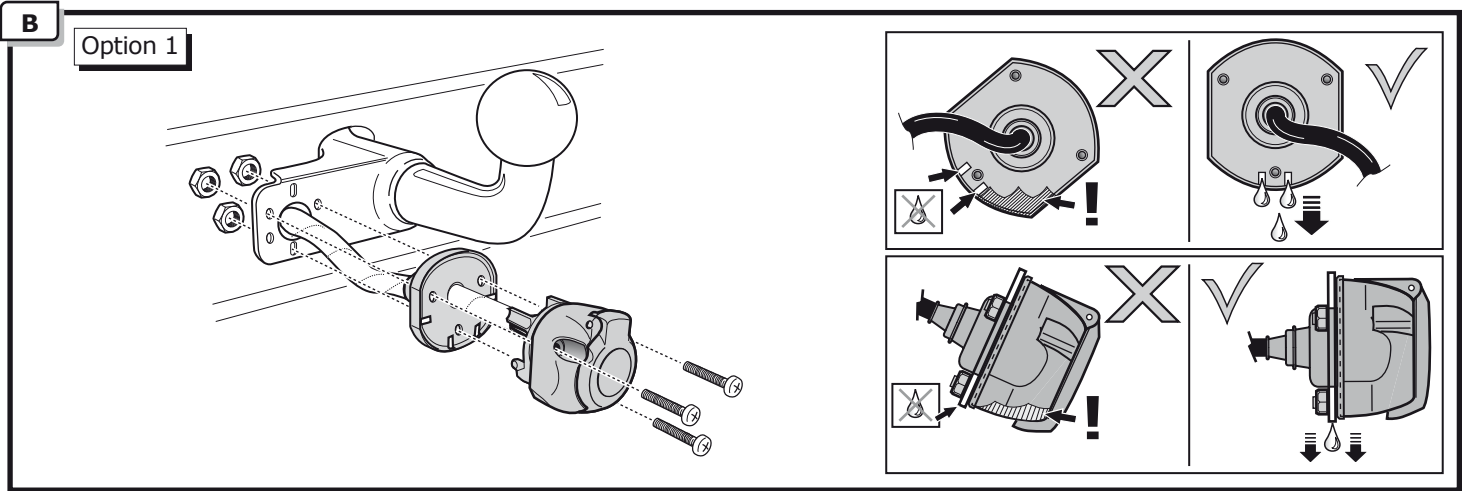

5

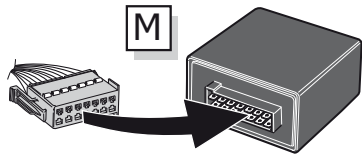

1



2

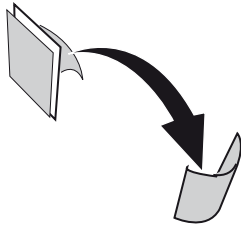

3

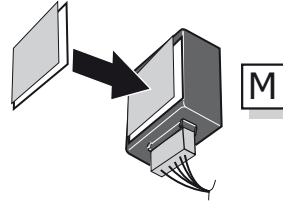

4

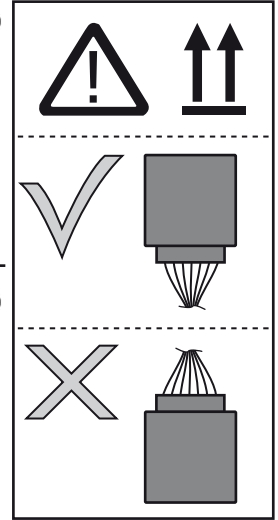
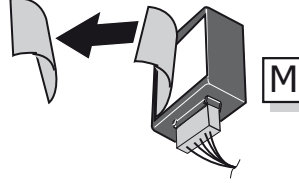

6

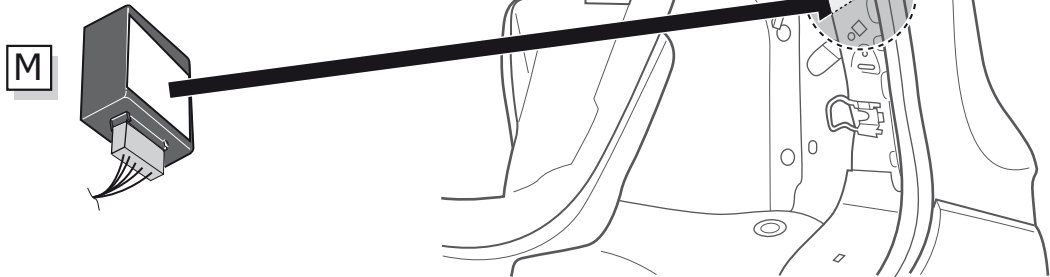
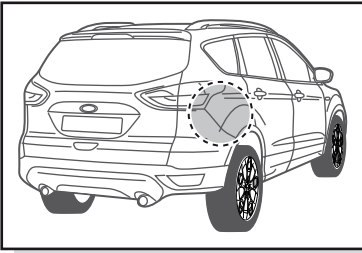

7

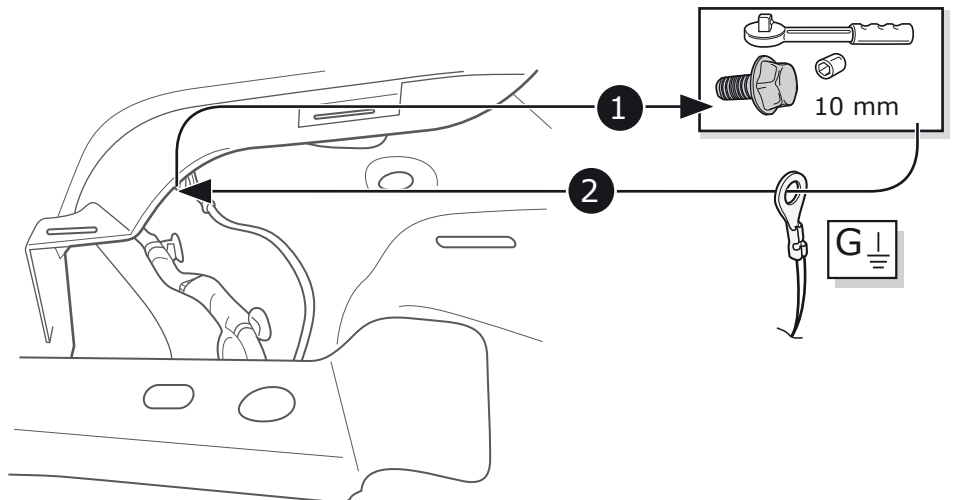
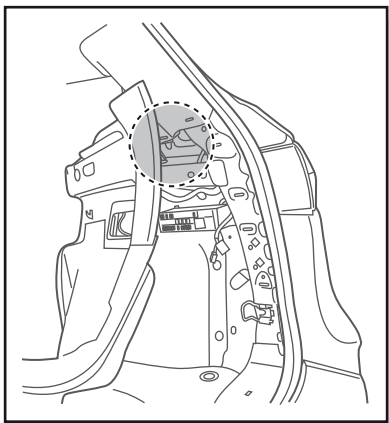

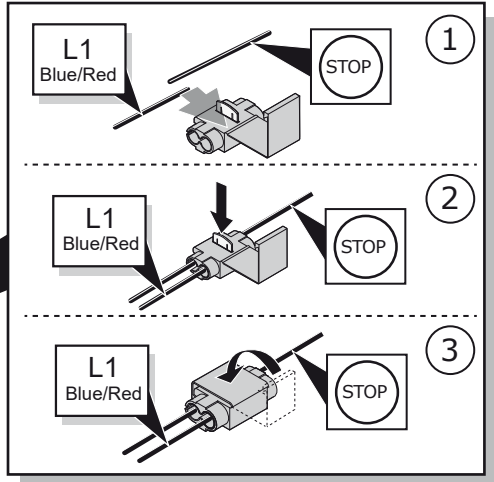
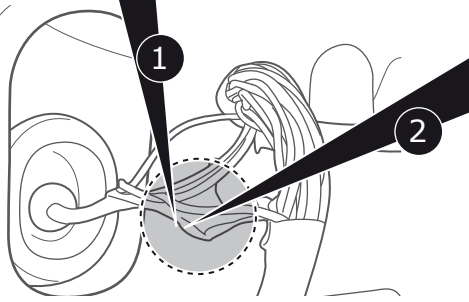
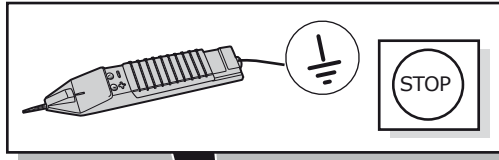
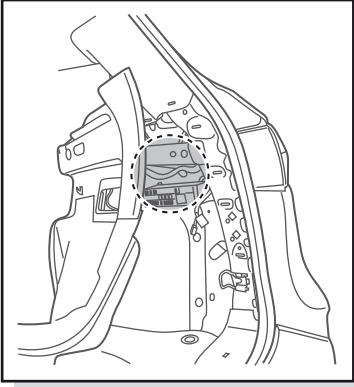

INFO

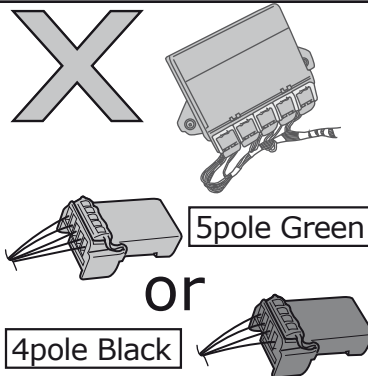
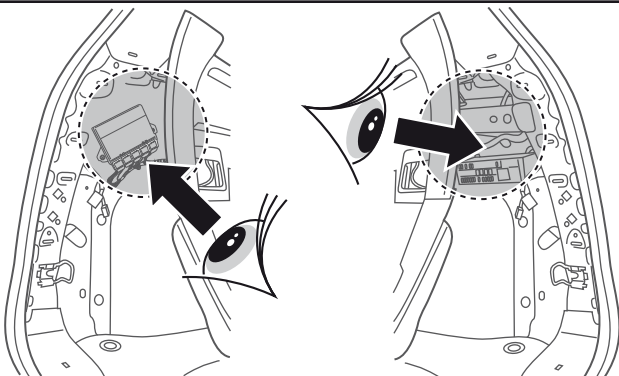
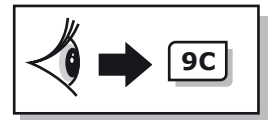
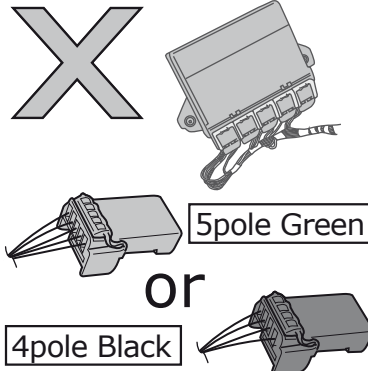
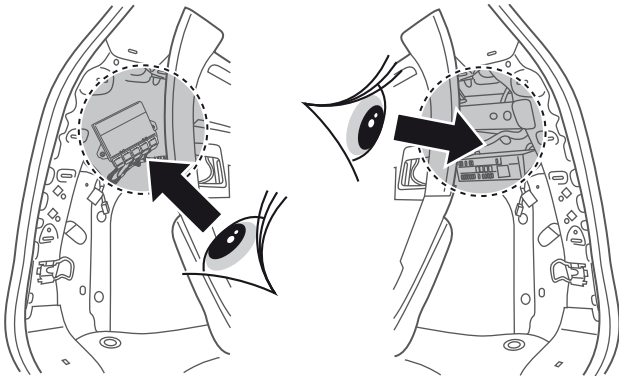
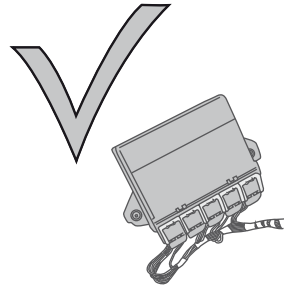
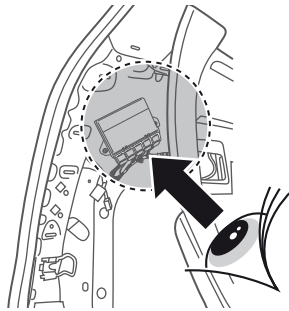
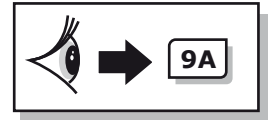
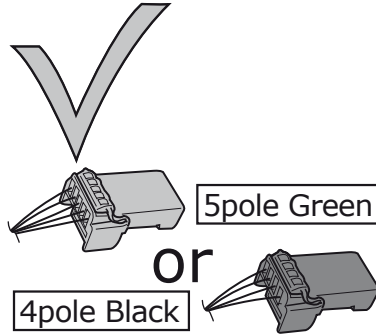
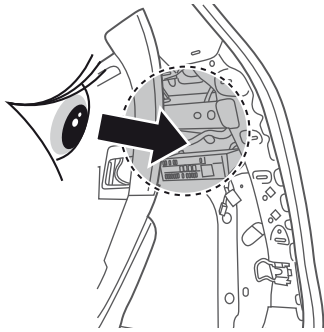

9A

**OPTION 1**

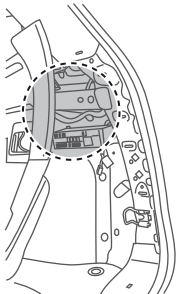
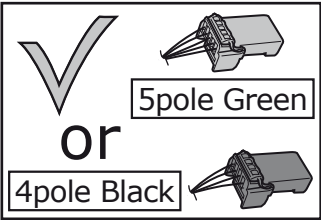
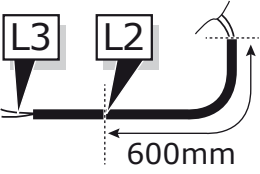

1

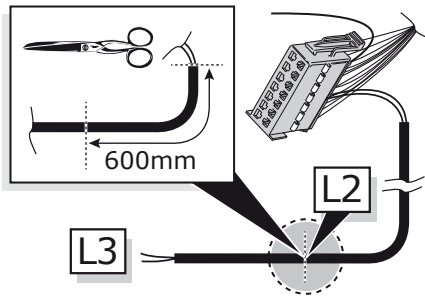

2

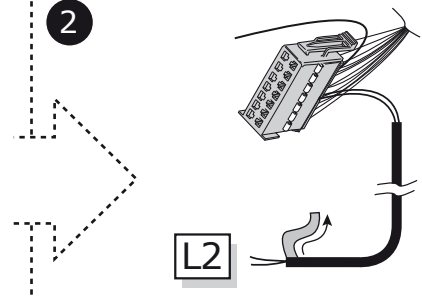

3

4pole Black

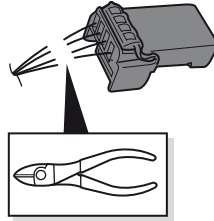

5pole Green

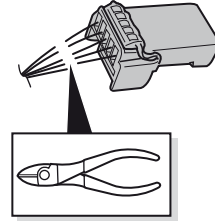

or

4



9B

**OPTION 2**

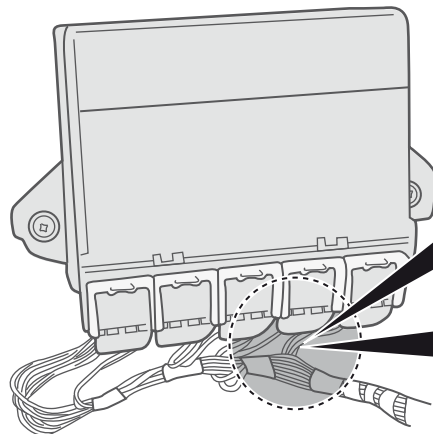
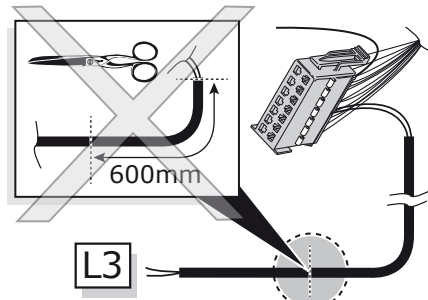
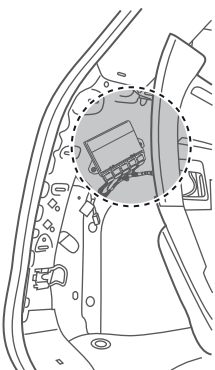
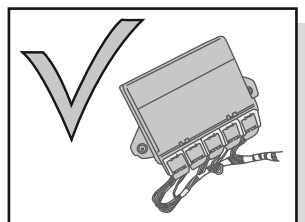

3

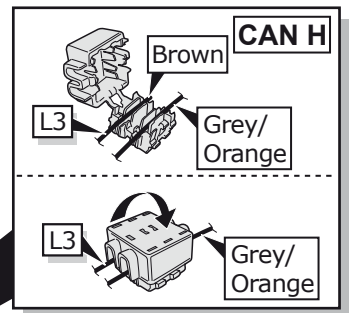

4

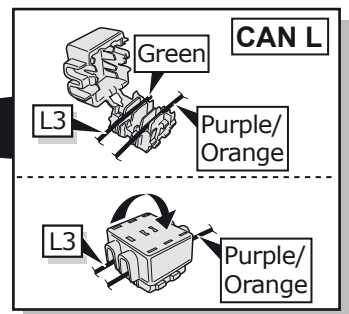



**OPTION 3**

L3

X

5pole Green

4pole Black

or

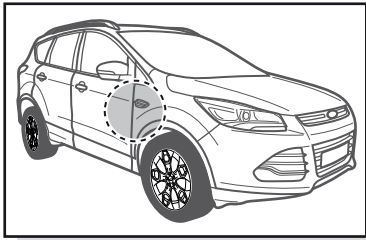
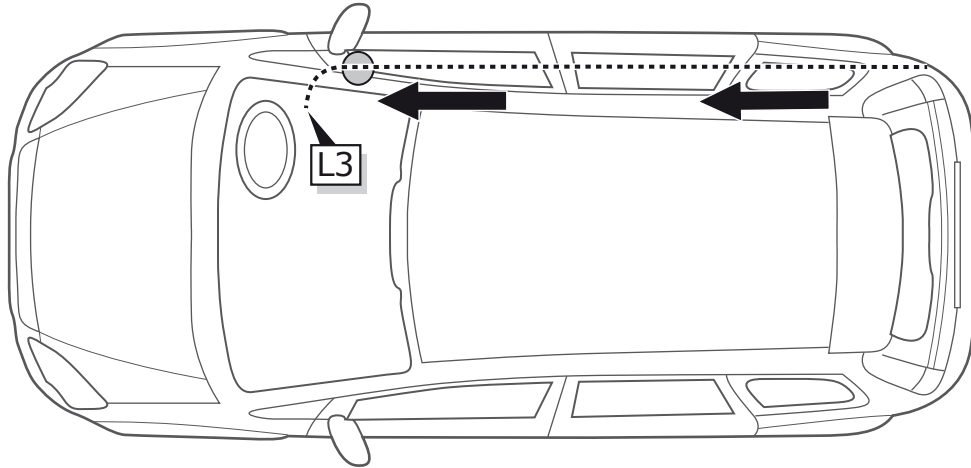
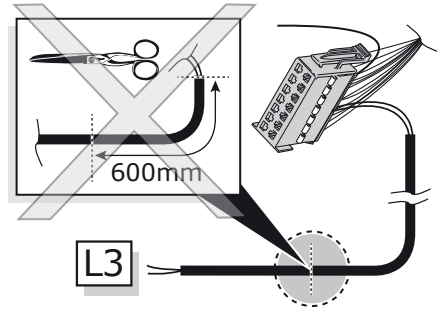

**CAN H**

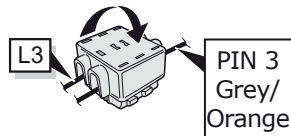
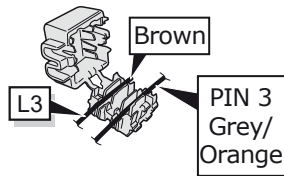

2

**CAN L**

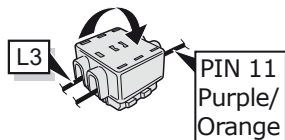
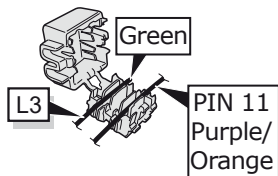

3

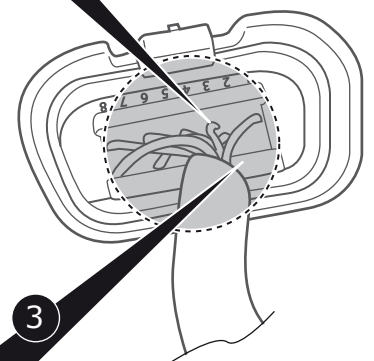
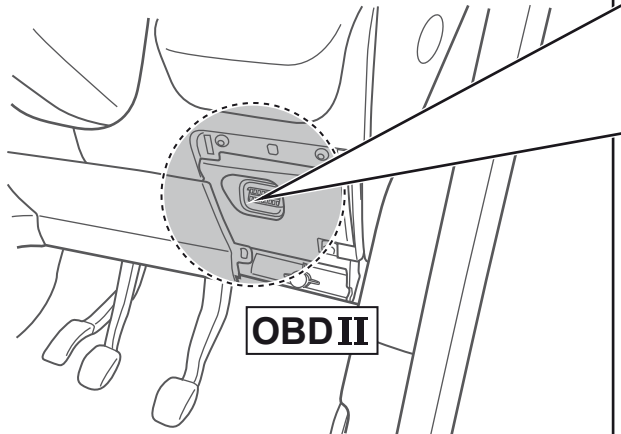

**OPTION 4**

L3

X

5pole Green

4pole Black

or

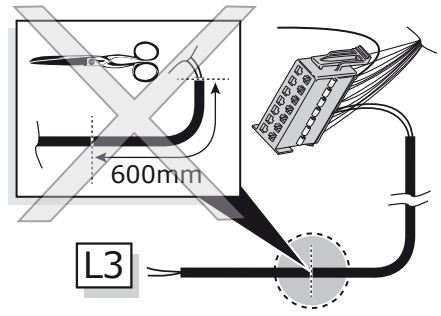

**KUGA 2017-**

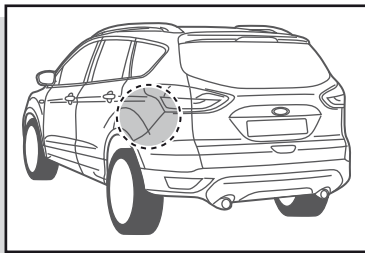
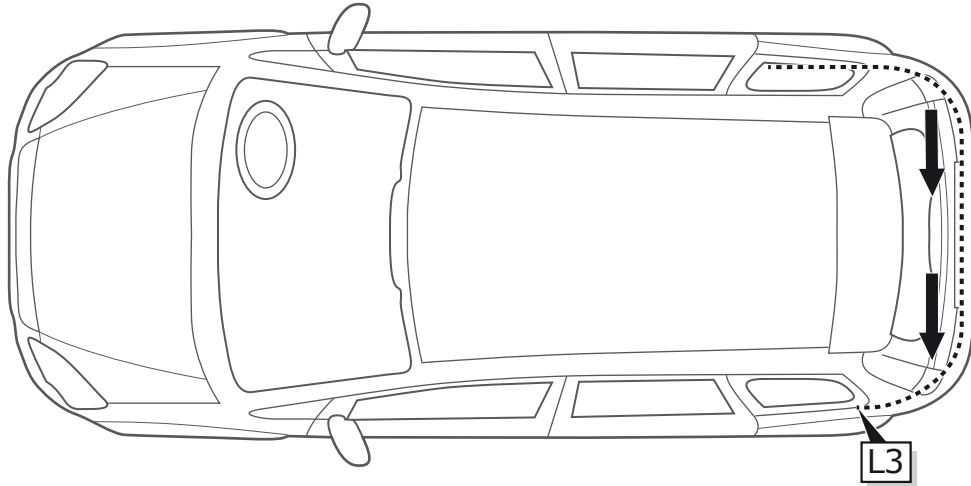

**CAN H**

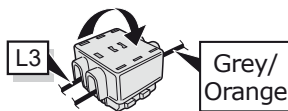
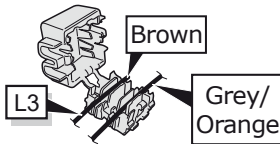

2

**CAN L**

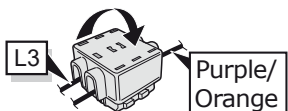
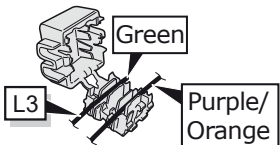

3

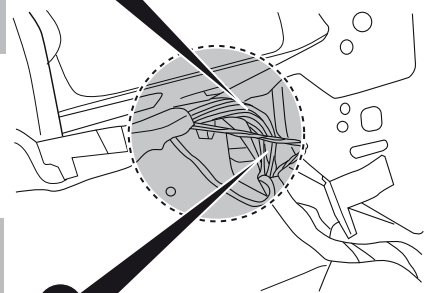
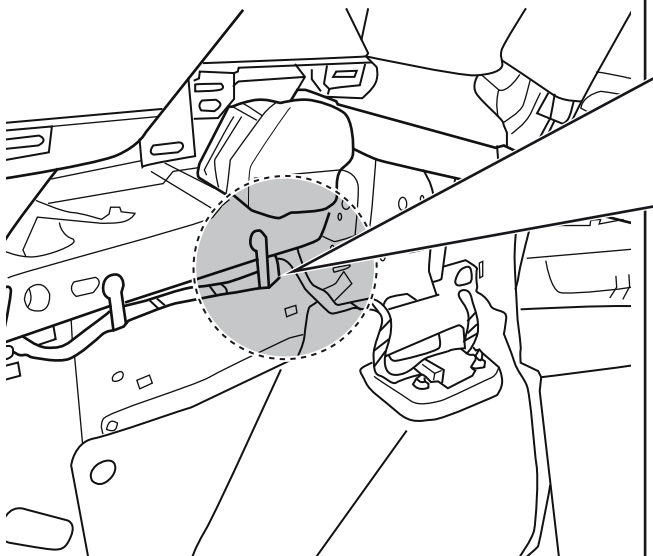

**INFO**

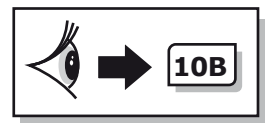
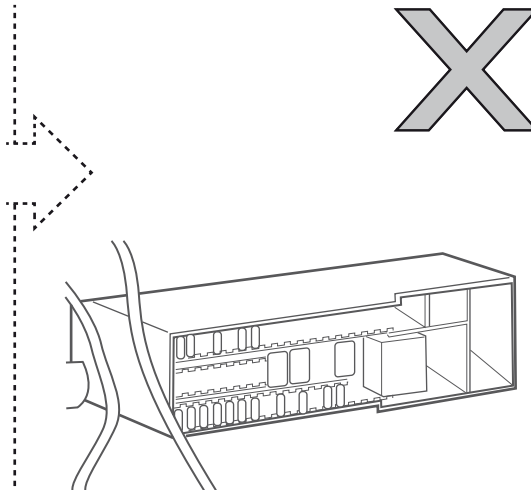
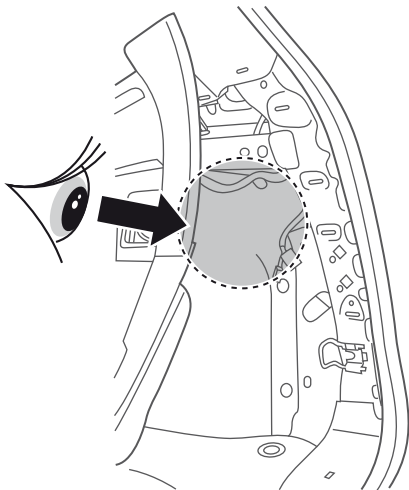
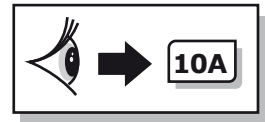
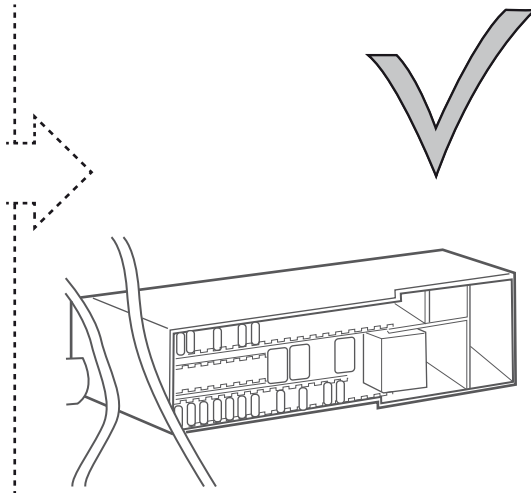
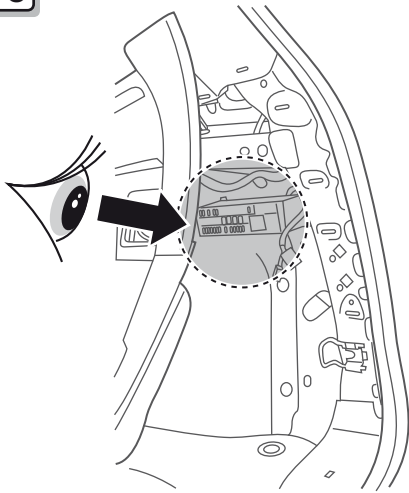

**10A**

**OPTION 1**

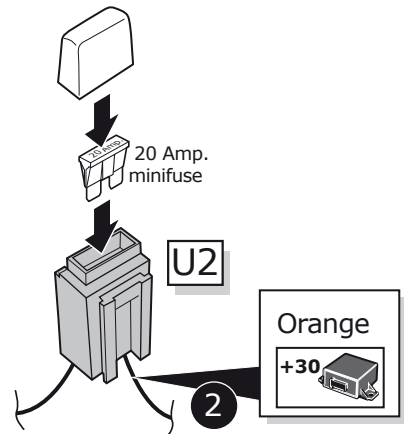
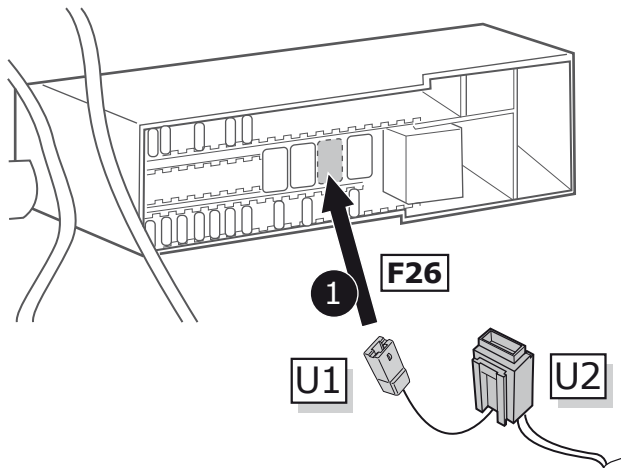
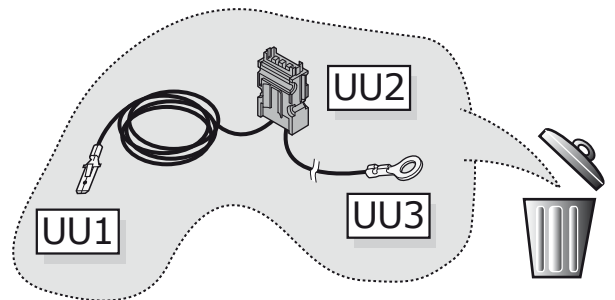
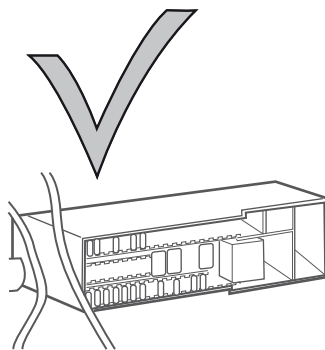
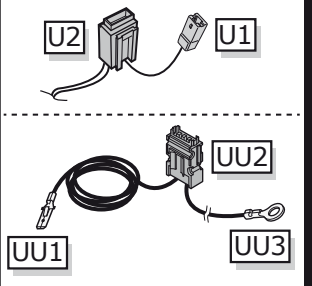

**OPTION 2**

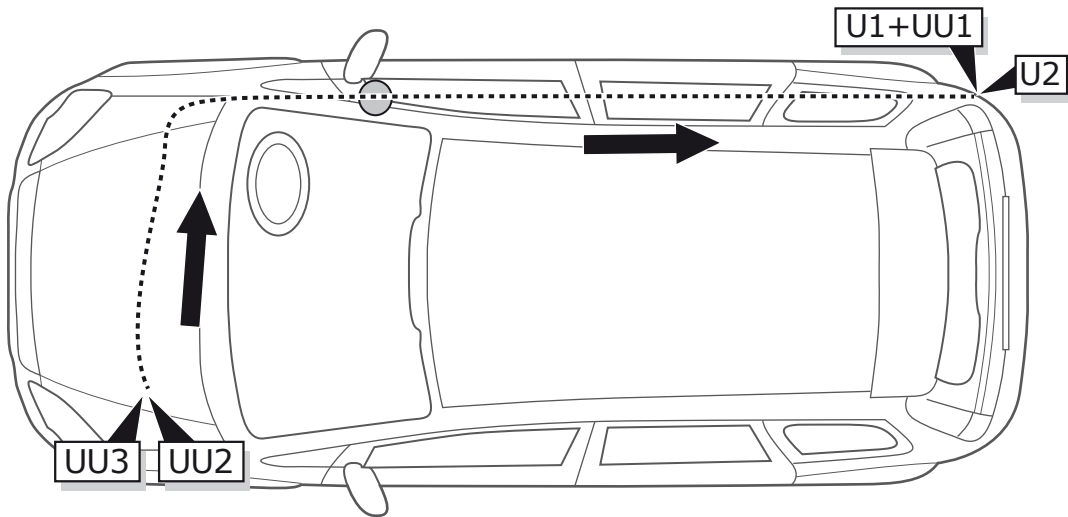
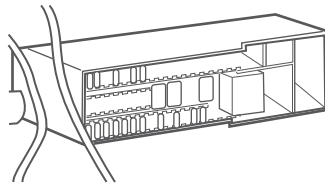
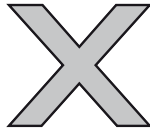
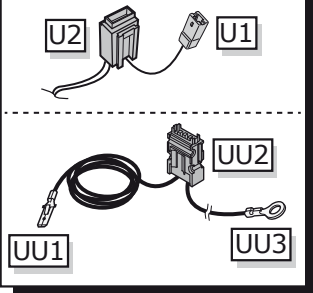

1

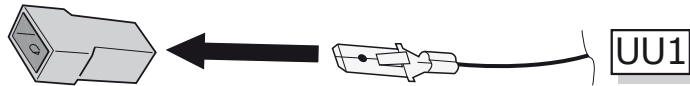

2



3

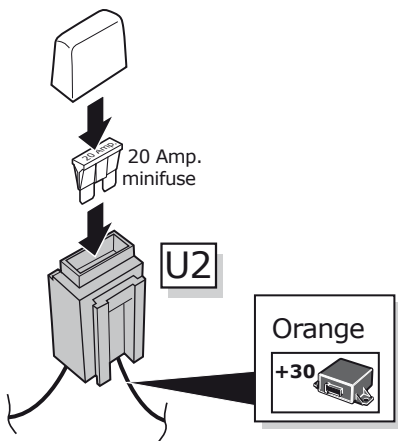

4

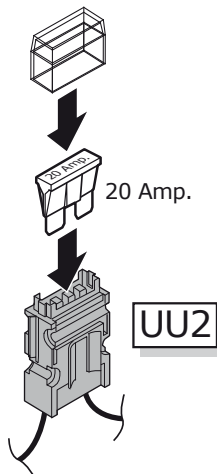

5

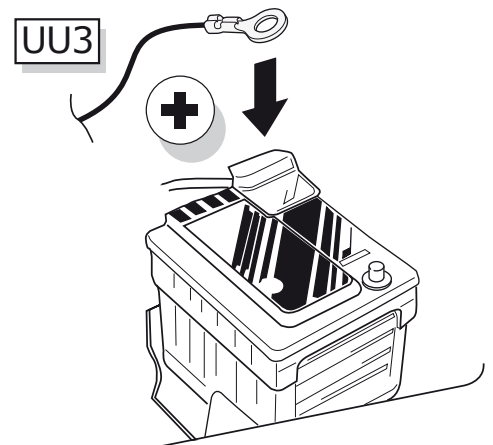

6

11

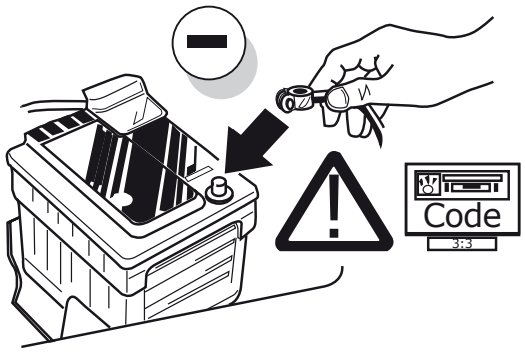

12

**Option 1**

**Manual PDC**

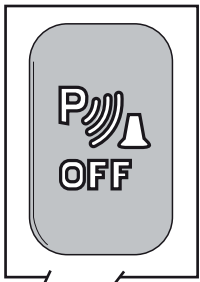

**Option 2**

**Auto PDC**

**C2**

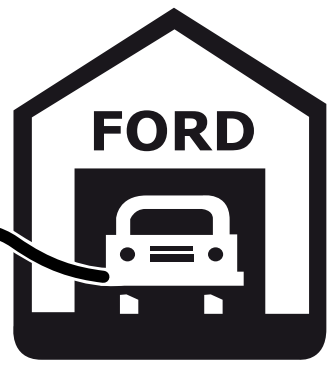
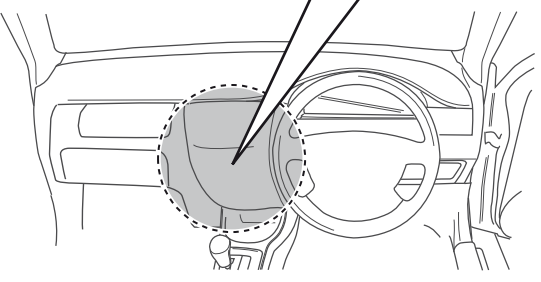

13

**Functional test**

				54 STOP

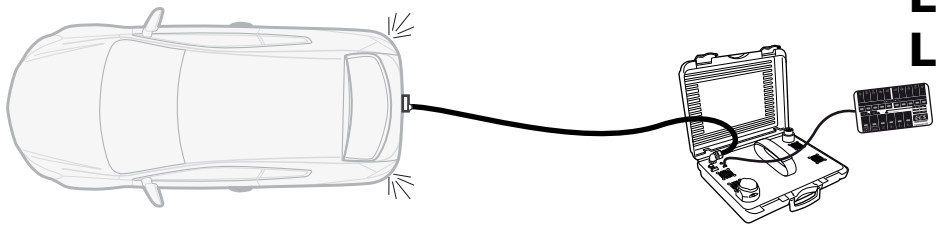
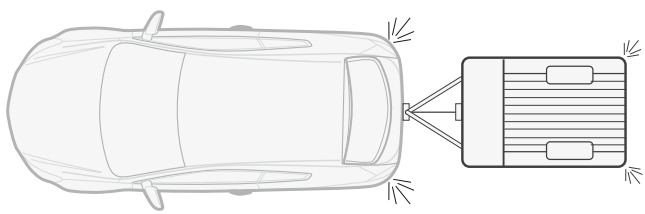

**WARNING**

**LIGHTMATE**

**ECS** part no.  
**LIGHTMATEII**  
**LIGHTMATEIII**

REINSTALL TRIM.

14

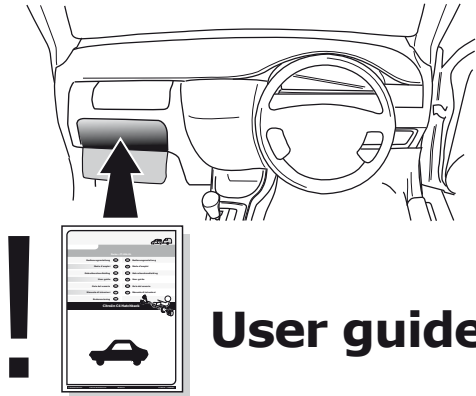

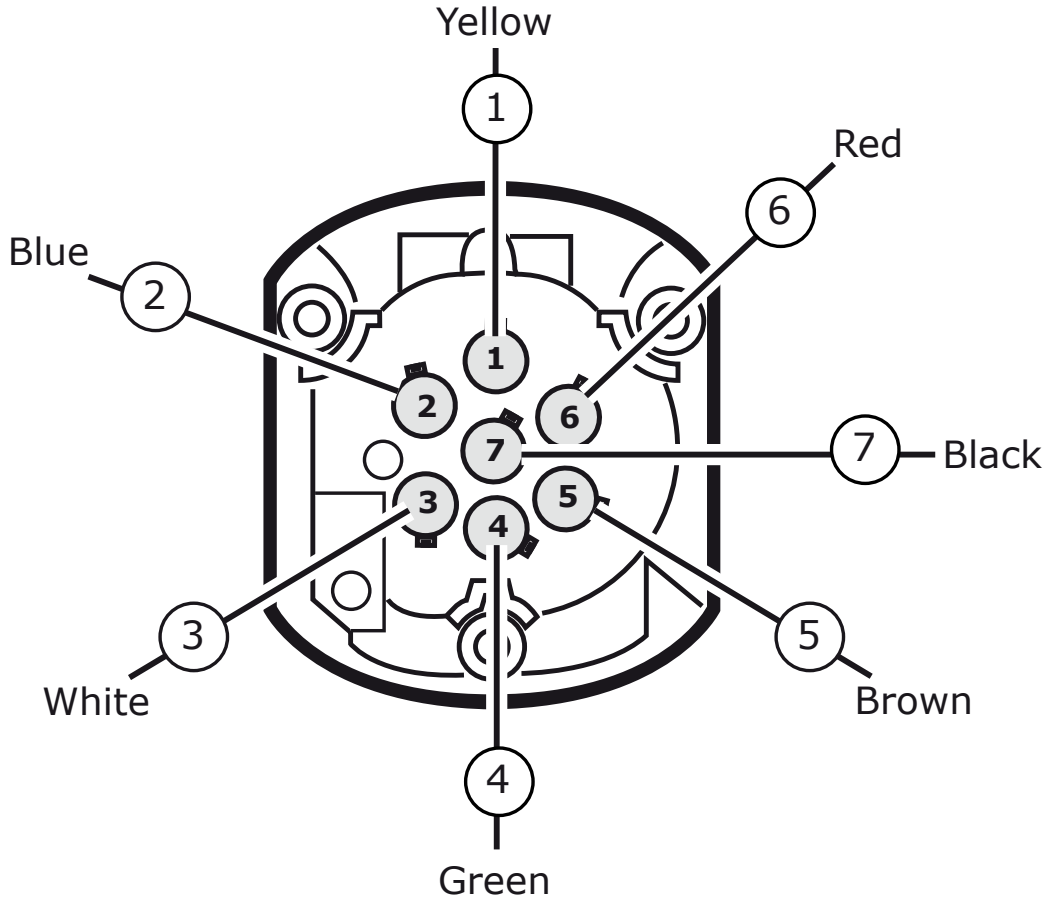
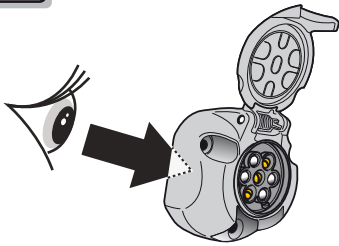

SOCKET CONNECTION

DIN/ISO 1724							
	1/L	2	3/31	4/R	5/58-R	6/54	7/58-L
Pmax	21W	21W		21W	42W	3x21W	42W
Colour	Yellow	Blue	White	Green	Brown	Red	Black

# UN-243-YZ Reverse lamp pre-wire extension

⚠ MAX = 21W

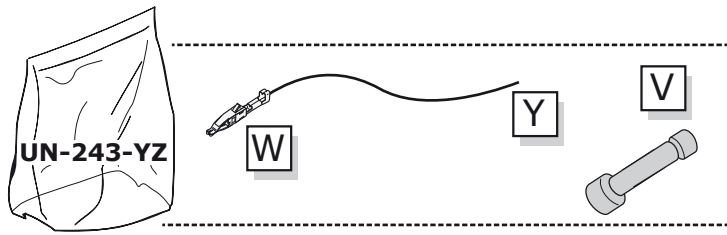

**A**

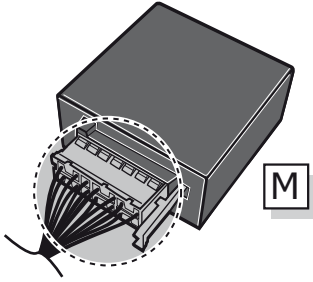

**1**

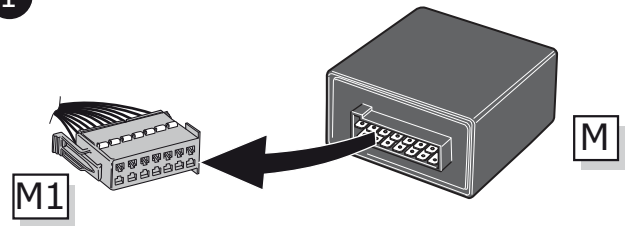

**2**

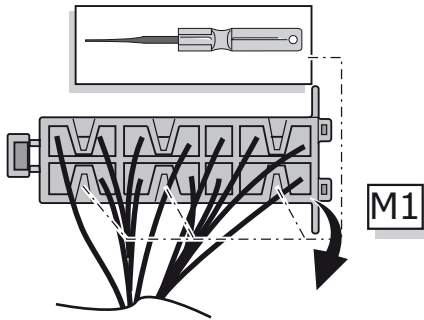

**3**

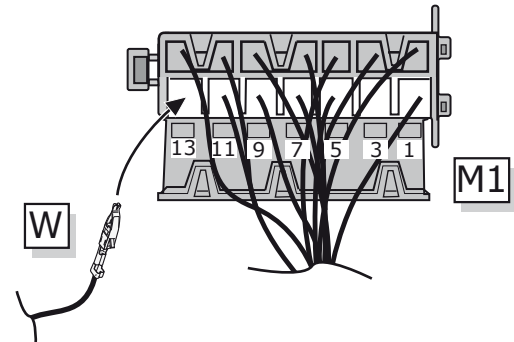

**4**

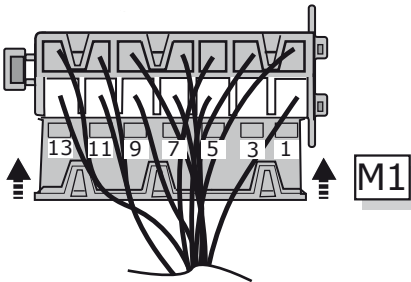

**5**

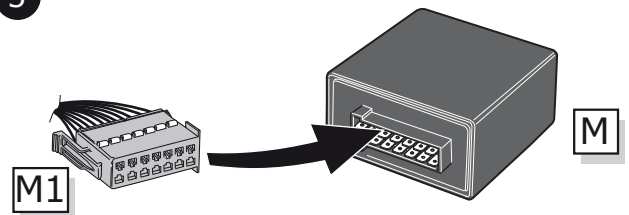

**B**

⚠ MAX = 21W

